



FACTS

ABOUT YOUR NEW HELMET
PLEASE, READ BEFORE WEARING HELMET

SZ/f SZ-RAM3

NOTICE: ALL PAINTED SURFACES ARE SUBJECT TO CHANGE, OVER TIME, DUE TO ENVIRONMENTAL FACTORS. SUCH CHANGES, SUCH AS FADING, ARE DUE TO THE EFFECTS OF SUN, VAPORS, CLEANING AGENTS, ETC. AND ARE TO BE CONSIDERED AS NORMAL WEAR AND TEAR AND, THEREFOR, NOT SUBJECT TO WARRANTY REPLACEMENT CLAIMS. IT SHOULD BE NOTED BY CONSUMERS CONTEMPLATING THE PURCHASE OF A HELMET WITH FLORESCENT (i.e. "DAY-GLO") SECTIONS TO ITS FINISH THAT THIS TYPE OF FINISH IS PARTICULARLY SUSCEPTIBLE TO EFFECTS OF THIS NORMAL WEAR AND TEAR.

Helmet Specifications Subject to
Change Without Notice.

Contact to:



ARAI HELMET, LIMITED
12 Azuma-cho, 2-chome
Ohmiya, Saitama
Japan 330-0841

ARAI HELMET (AMERICAS), LIMITED
P.O. Box 9485
Daytona, FL 32120
U.S.A

ARAI HELMET (EUROPE), B.V.
P.O. Box 112
3870 CC Hoevelaken
The Netherlands

We wish to take this opportunity to thank you for purchasing one of our ARAI helmets. We are confident that it will meet with your satisfaction and we offer this booklet of information to enhance your enjoyment of your new helmet. As the oldest manufacturer of safety helmets in Japan, ARAI has always been in the forefront of the helmet technology and we continue today as one of the leaders in the art and science of making helmets. However, even when built to the best of the current "state of the art", no helmet can guarantee absolute safety. Your helmet's function is to reduce the chance of severity of injury in an accident. Some reasonably foreseeable impacts may exceed any helmet's ability to protect against injury. Please bear this in mind when you ride and ride safely.

NOTES ON USE

The basic function of the helmet, to protect the head from the effects of a severe blow is accomplished by surrounding the head with a certain amount and type of material and space which work as a shock absorber and buffer. For optimum safety, a substantial amount of material is needed around the head. Therefore, although negligible, some degree of hearing, peripheral vision and physical movement may be sacrificed in order to properly protect your head. Remember this and ride accordingly.

For maximum safety, it is important that your helmet be a snug, comfortable fit on your head. It should not be too large so as to dance around on your head nor so small that it constricts and causes pain. When trying to move the helmet on the head, either in rotation and/or fore & aft, the skin should be pulled by the lining. If the lining slips easily over the skin the helmet is too large.

In the event of an accident, you will be subject to impacts that can come from any direction. Some may tend to lift the helmet from your head. Therefore, it is imperative that your chinstrap is securely fastened, keeping your helmet firmly in place whenever you ride.

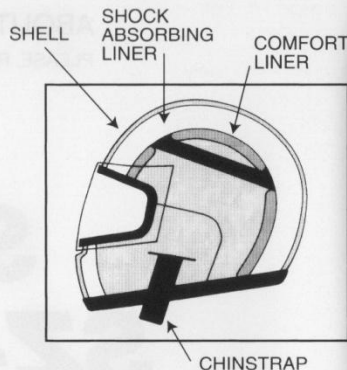

Although your helmet is solidly built, like any fine piece of equipment, it should be handled with care. Dropping onto solid surfaces and other rough handling may damage the painted surface and/or decrease its ability to protect.

Use soft cloth with detergent and lukewarm water solution to clean both the inside and outside of your helmet. Never use petrol, thinner, benzene or any other solvents as these can adversely effect the shock absorbing liner and plastic components.

It is extremely dangerous to modify your helmet as it may decrease the ability to protect. For safety's sake, do not drill any holes in the shell or press or cut the shock absorbing liner. Use only ARAI's genuine parts when you replace parts of your helmet.

If painting your helmet, be sure to protect the entire inside of the helmet from the paint spray by masking all openings with paper and tape as paint can adversely effect the shock absorbing liner and plastic components. IMPORTANT: Do not remove any non-replaceable parts; eye-trim, edge-trim, chin straps, E.P.S.(styrofoam)liner, etc., etc. when preparing to paint. It is not possible to reinstall these items properly. Carefully mask trims before painting. Use only air drying paint, not paints that require heat curing.

As is the nature of a good helmet, this helmet is so constructed that the energy of a severe impact is absorbed through partial destruction of the shell and/or liner. Such damage may not be visible to the naked eye. If the helmet suffers such an impact, and any doubt exists as to its further ability to protect, it should either be returned to the manufacturer for competent inspection or discarded and replaced by a new ARAI helmet.

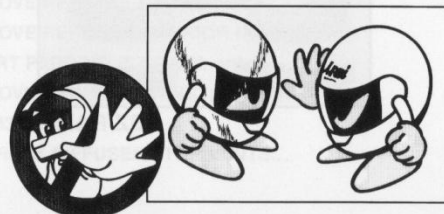
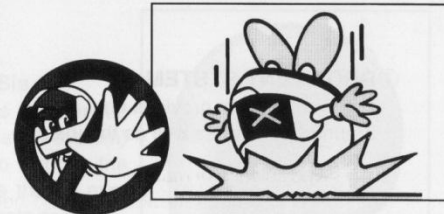

① BROWVENT SYSTEM

Browvent system provides cool air around forehead as well as the interior.

**② REMOVA/REPLACEABLE EAR CUPS (SZ/f)
FULLY REMOVAL/REPLACEABLE HEAD LINING COMFORT PADDING & CHINSTRAP COVERS (SZ-RAM3)**

Removal/replaceable ear cups keep providing a fresh fit by washing them when they become dirty, or give you a more custom fit and comfort by allowing you to replace standard cups with optional sizes closer to your individual facial contour. In addition, SZ-RAM3 has removable/replaceable head lining comfort padding and chinstrap covers which are washable and the head lining comfort padding is replaceable with optional sizes for a more comfort fit and comfort.

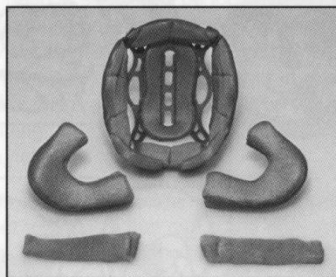

(SZ-RAM3)

**③ TOP VENT SYSTEM (SZ/f)
DIFFUSER SYSTEM (SZ-RAM3)**

Top vent/Diffuser system draws out hot air and moisture from inside the helmet.



(SZ-RAM3)

④ SUPER AdSis

Super AdSis (Advanced Shield installation system) allows you to remove the shield in less than a minute with no tools or shims.



⑤ THE CHINSTRAP END-STRAP SNAP AND A D-RING RELEASE TAB

The chinstrap end-strap snap prevents flapping, and a D-ring release tab makes the loosening of the rings easier.

⑥ REAR EXHAUST VENTS (SZ-RAM3)

Rear exhaust vents draw out hot air inside the helmet.

CONTENTS OF FOLLOWING PAGES

- A** TO OPERATE CHINSTRAP.....
- B** TO OPEN/CLOSE FACE SHIELD.....
- C** TO OPERATE BROWVENTS.....
- D** TO REMOVE/REPLACE FACE SHIELD.....
- E** TO REMOVE/REPLACE SHIELD HOLDING ARMS.....
- F** TO REMOVE/REPLACE EAR CUPS.....
- G** TO REMOVE/REPLACE INTERIOR HEAD LINING COMFORT PADDING (SZ-RAM3 only)
- H** TO REMOVE/REPLACE CHINSTRAP COVERS (SZ-RAM3 only)
- I** TO OPERATE DIFFUSER / TOP VENTS...

A TO OPERATE CHINSTRAP.....

For proper fastening the chinstrap must be routed through the D-rings as illustrated < 1 > and pulled through them securely.

<1>

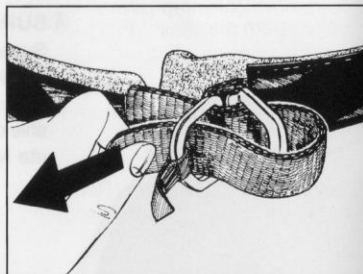

The end-strap snap is provided only to allow the wearer to prevent the end of the strap from flapping in the air stream < 2 >.

WARNING: It is not part of the retention system and should not be relied upon even when carrying the helmet by the strap as it will release under little stress.

<2>

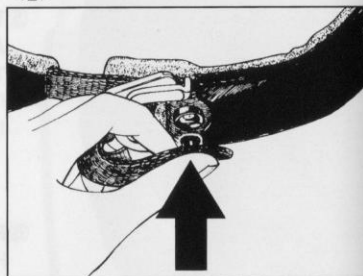

A D-ring release tab is provided to make the loosening of the rings easier. Simply pull as illustrated in < 3 >.

<3>

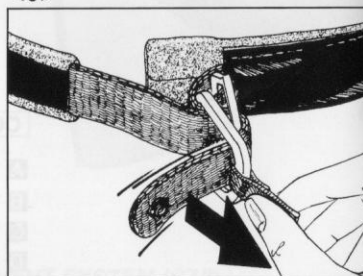

B TO OPEN/CLOSE FACE SHIELD...

Pull outward on lower left side of shield to release lock system and then raise shield. The shield can only be opened when the lock system has been so released.



To close the shield smoothly, push down on the middle of the upper edge of the shield. Be sure the shield is locked before you operate your motorcycle.



Apply one or two drops of supplied silicone lubricant around edge trim and on other moving parts and wipe off with soft tissue paper to maintain proper operation.

NOTE; Only use Arai genuine silicon lubricant supplied with your helmet or sold at your Arai dealer. The use of non-Arai silicon lubricant may result in damage to the plastic components. There are many "aggressive" cleaners on the market, including some supposed to be specifically for use on helmet and faceshields (visors). Arai strongly recommends that you do not use any such products to clean your helmet as some of their ingredients may have damaging effects on the ancillary plastic parts installed on it. Use only mild soap and luke warm water to clean the interior and exterior of your Arai helmet.

C TO OPERATE BROWVENT....

The Browvents are operated from fully closed through intermediate, to fully open positions by simply pulling the louver control down to open, pushing up to close

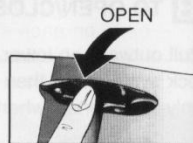

D TO REMOVE/REPLACE FACE SHIELD....

To remove the shield, first place it in the fully open position.

When the shield is in its fully open position, levers appear under the shield holding arms.<1>



<1>

Push these levers straight forward in the arrowed direction until they stop (about 5mm, 1/8"), which releases the locking system.<2.left 2.right>

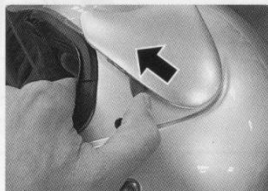

<2.left>



<2.right>

Then, raise the shield further to remove shield assembly from helmet.<3>



<3>

NOTE: The shield cannot be removed from any other position as the locking system will be engaged

To replace shield, place each shield holding arm onto base plate on each side so that the lower edge of the arm on each side lines up with the guide line marked on each base plate <4>

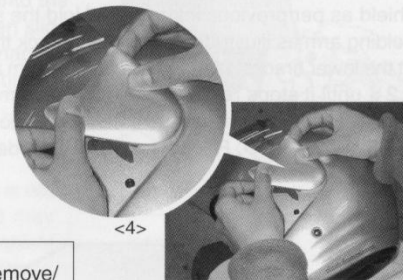

<4>

NOTE: The shield can only be replaced at its remove/replace position. Check its angle as you remove the shield and duplicate it to replace the shield



<5>

Push firmly inward on the shield holding arms until you hear them click into place < 5 >
Lower the shield past the normal upper stops < 6 >, and test operation. if the shield does not seem to work properly, remove and gently reinstall it again.



<6>

WARNING: Do not use oils or waxes to lubricate vents or other moving parts. If you must lubricate such components please sparingly use the silicone lube provided with your helmet for eyepoint trim dressing.

E TO REMOVE/REPLACE SHIELD HOLDING ARMS.....

To take the shield holding arms off the shield, remove shield as per previous instruction. Hold the shield/shield holding arm as illustrated < 1 >. Push back the lock lever at the lower bracket of the shield holding arm as illustrated < 2 > until it stops releasing the lock system. Then slide the shield holding arm upward < 3 >, and remove the shield as illustrated < 4 >. Repeat for the other side.

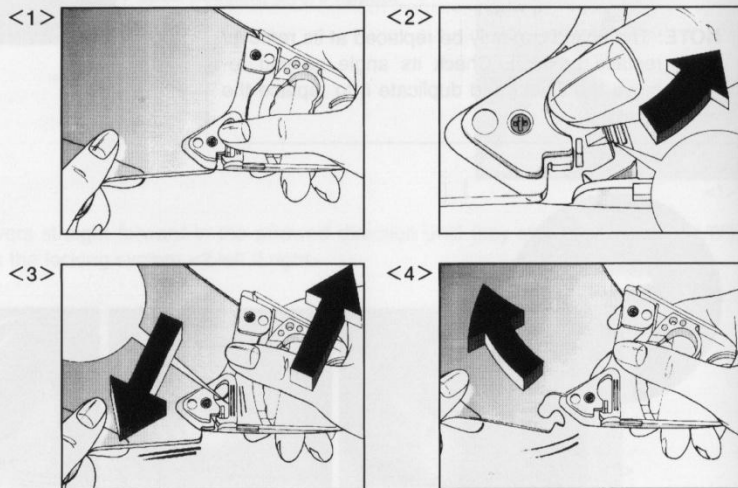

To replace the shield holding arms, first slip the upper slot of the shield into the upper bracket of the shield holding arm < 1 >, next slip the lower slot of the shield into the lower bracket of the shield holding arm < 2 >, then slide the shield holding arm downward until it is fully snapped into place < 3 >. Be sure the lock lever at the lower bracket returns to the correct position as illustrated < 4 >.

WARNING: If the lock lever at the lower bracket is not in the correct position, the shield may come off when you try to replace the shield or when you operate your motorcycle.

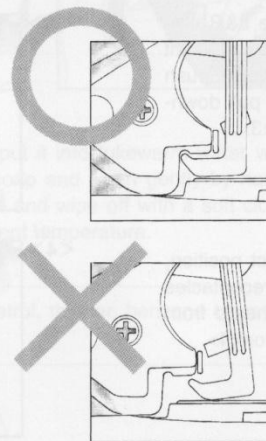
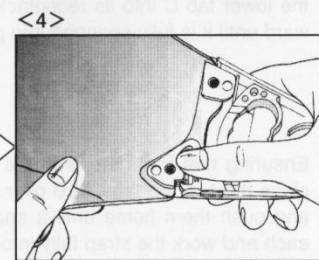
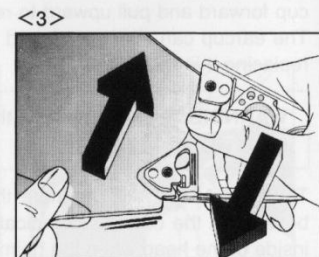
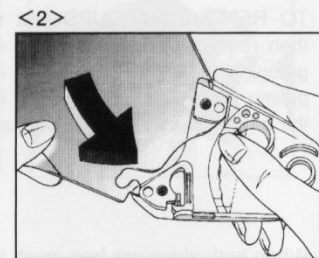
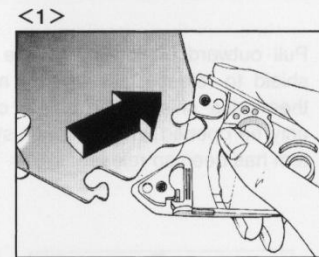

F TO REMOVE/REPLACE EARCUPS...

Pull outward on lower left side of shield to release lock system and then raise shield. The shield can only be opened when the lock system has been so released.

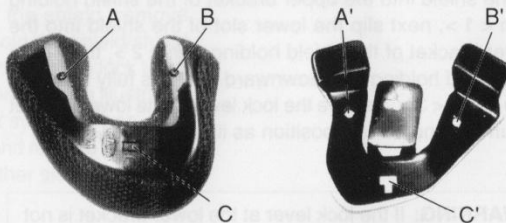

TO REMOVE EARCUPS first undo chinstraps, then remove bosses A&B from its base plate by grasping upper part of earcup on one side and pulling toward you until a snap is heard, then do the other side of the same earcup<1>.

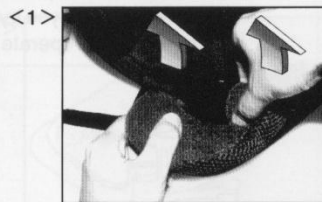

When both sides are free, push lower part of earcup forward and pull upward to release tab C<2>. The earcup can now be washed and dried before replacing it in the helmet.

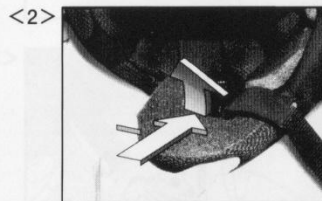

WARNING:Never use petrol, thinner, benzene or any other solvents

TO REPLACE EARCUP (note that the L&R embossed on the cup bases indicate Left and Right inside of the head when the helmet is worn), push the lower tab C into its receptacle and pull downward until it is fully snapped into place<3>.

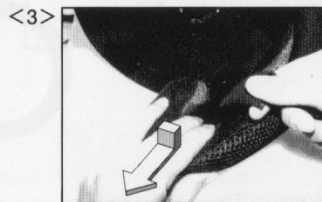

Ensuring that the strap is in the correct position, place the two top tabs A&B over their receptacles and push them home until a snap is heard from each and work the strap fully into position<4>.

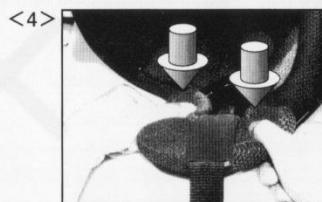

G TO REMOVE/REPLACE INTERIOR HEAD LINING COMFORT PADDING (SZ-RAM3 only)...

The interior pad is secured to the helmet by the 4 bosses. To remove the interior pad, undo 4 bosses by grasping interior pad as close to each boss as possible. Observe the fore & back, top & bottom sides of the interior pad for replacement.



To replace the interior pad, place the 4 bosses over their receptacles and push them home.

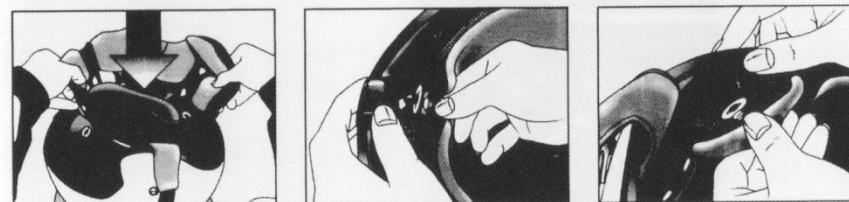

To wash the interior pad, put it into lukewarm water with small amount of laundry soap and wash gently by hand. Rinse well with fresh water and wipe off with a soft cloth. Dry it in the shade at ambient temperature.

WARNING:Never use petrol, thinner, benzene or any other solvents.

Replaceable toppad/perimeterpad is available in 4 thicknesses. Select your size for a more custom fit and comfort with reference to the standard comfort padding thicknesses chart below.

The interior toppad/perimeterpad size is different in each helmet shell size and cannot be replaced with other interior toppad/perimeterpad sizes. Be sure to select the right interior toppad/perimeterpad size for your helmet.

SZ-RAM3 INTERIOR PAD THICKNESS CHART

HELMET SIZE	COMFORT PADDING SIZE	12mm	10mm	7mm	5mm
XSM	II		std		
SML				std	
MED	III		std		
LGE				std	
XLG	IV			std	
XXL					std

SPECIFICATIONS SUBJECT TO CHANGE WITHOUT NOTICE

H TO REMOVE/REPLACE CHINSTRAP COVERS (SZ-RAM3 only).....

To remove chinstrap covers, first remove ear cups as per previous instruction.

Grasp plastic tab plate at upper part of chinstrap cover and pull upward to release tab from its base plate. Slide the cover off the chinstrap. Repeat for the other side

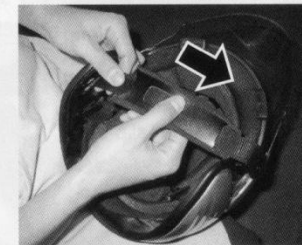
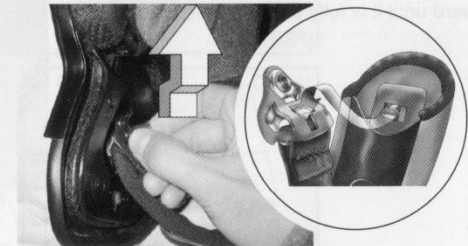

Note the right and left, inside and outside of the chinstrap covers for replacement

left chinstrap cover (D-Ring side)

right chinstrap cover (long side)

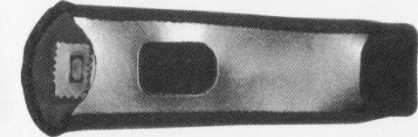
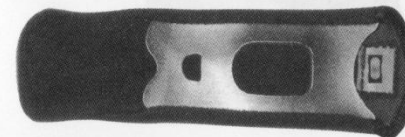

To replace the left chinstrap cover (D-Ring side), ensure the female Chinstrap End-Strap Snap side of the chinstrap and the leatherette-side of the chinstrap cover both face outward, slip chinstrap cover onto the chinstrap.

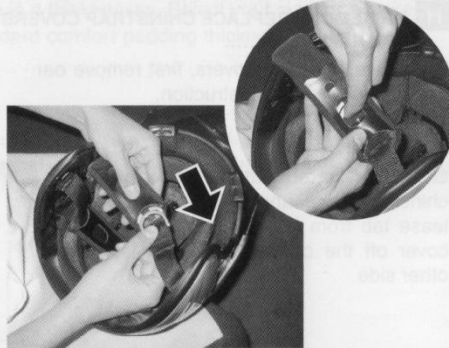

Position plastic tab plate over the base plate, push tab into the receptacle and pull downward until it is fully snapped into place.

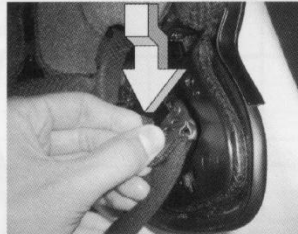

To replace the right chinstrap cover (long side), ensure the cap side of Chinstrap End-Strap Snap (Arai logo impressed) on the chinstrap and the leatherette-side of the chinstrap cover both face outward, slip chinstrap cover onto the chinstrap.

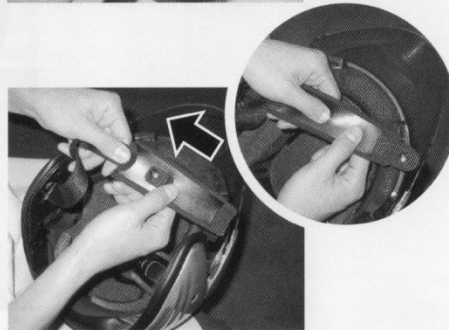

Position plastic tab plate over the base plate, push tab into the receptacle and pull downward until it is fully snapped into place.

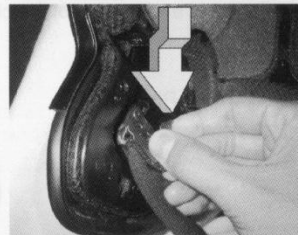

Replace the cheekpads as per previous instruction.

I TO OPERATE DIFFUSER / TOP VENTS...

Simply push the switches on each duct to open/close the ducts as illustrated.

NOTE; The diffusers / top vents are installed on the helmet with double adhesive tape. Do not try to remove them as damage may result.

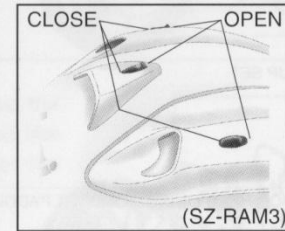
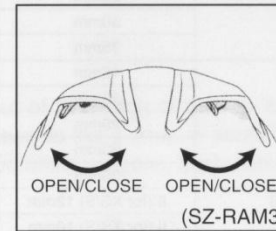
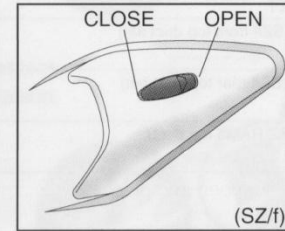
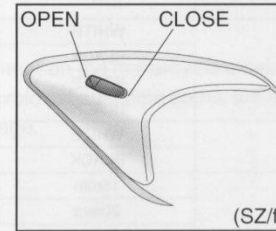

ARAI REPLACEMENT & OPTIONAL PARTS LIST

PARTS	COLOR or SIZE	PART#
SUPER AdSis ZR-TYPE SHIELD	CLEAR	1565
	DARK-TINT	1566
	LIGHT-TINT	1567
SUPER AdSis ZF TYPE SHIELD HOLDING ARM SET	WHITE	3400
	BLACK	3401
SUPER AdSis ZF (w/LRS) TYPE BASE PLATE SET		3016
AdSis SCREW SET		2511
TDF DUCT SET (SZ/f front top duct set)	WHITE	3450
	BLACK	3451
TDR DUCT SET (SZ/f rear top duct set)	WHITE	3470
	BLACK	3471
DELTA DUCT4 (SZ-RAM3 top duct)	WHITE	1880
	BLACK	1891
SZ/f EARCUP SET	15mm	3442
	20mm	3443
	25mm	3444
	30mm	3445
	35mm	3446
SZ-RAM3 EARCUP SET	15mm	3692
	20mm	3693
	25mm	3694
	30mm	3695
	35mm	3696
SZ-RAM3 INTERIOR HEAD LINING COMFORT PADDING	II (for XS/S) 12mm	3680
	II (for XS/S) 10mm	3681
	II (for XS/S) 7mm	3682
	II (for XS/S) 5mm	3683
	III (for M/L) 12mm	3684
	III (for M/L) 10mm	3685
	III (for M/L) 7mm	3686
	III (for M/L) 5mm	3687
	IV (for XL/XXL) 12mm	3668
	IV (for XL/XXL) 10mm	3688
IV (for XL/XXL) 7mm	3689	
IV (for XL/XXL) 5mm	3669	
SZ-RAM3 CHINSTRAP COVER SET		3610

SPECIFICATIONS SUBJECT TO CHANGE WITHOUT NOTICE

MORE PARTS, COLORS & DESIGNS ARE AVAILABLE. CONTACT YOUR ARAI DEALER OR THE NEAREST ARAI REPRESENTATIVE OFFICE LISTED ON THE BACK COVER FOR CURRENT AVAILABILITY

Do not "park" helmet on mirror stalks or sissy bars to avoid damage to liner.

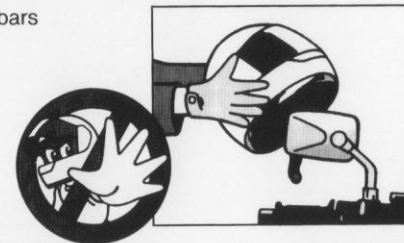

Do not carry helmet on the motorcycle's helmet lock while riding to avoid exhaust pipe burns, tire abrasion, and strap damage.

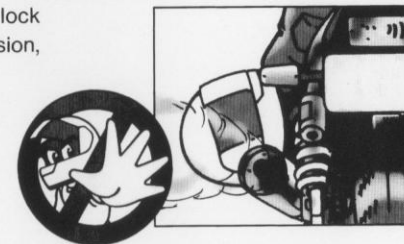

Keep helmet out of the reach of pets to avoid the interior being chewed like a shoe, or scratched, like a sofa, as all too often happens. Such damage can be irreparable.



Do not expose helmets to solvents including gasoline, or their fumes to avoid damage to shields, small plastic components and interior.

